

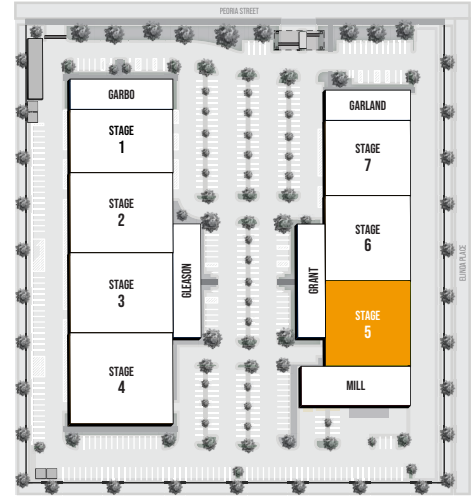

SUNSET GLENOAKS · STAGE 5

11100 Peoria St, Sun Valley, CA 91352 · Sales@SunsetStudios.com · (323) 860-8100

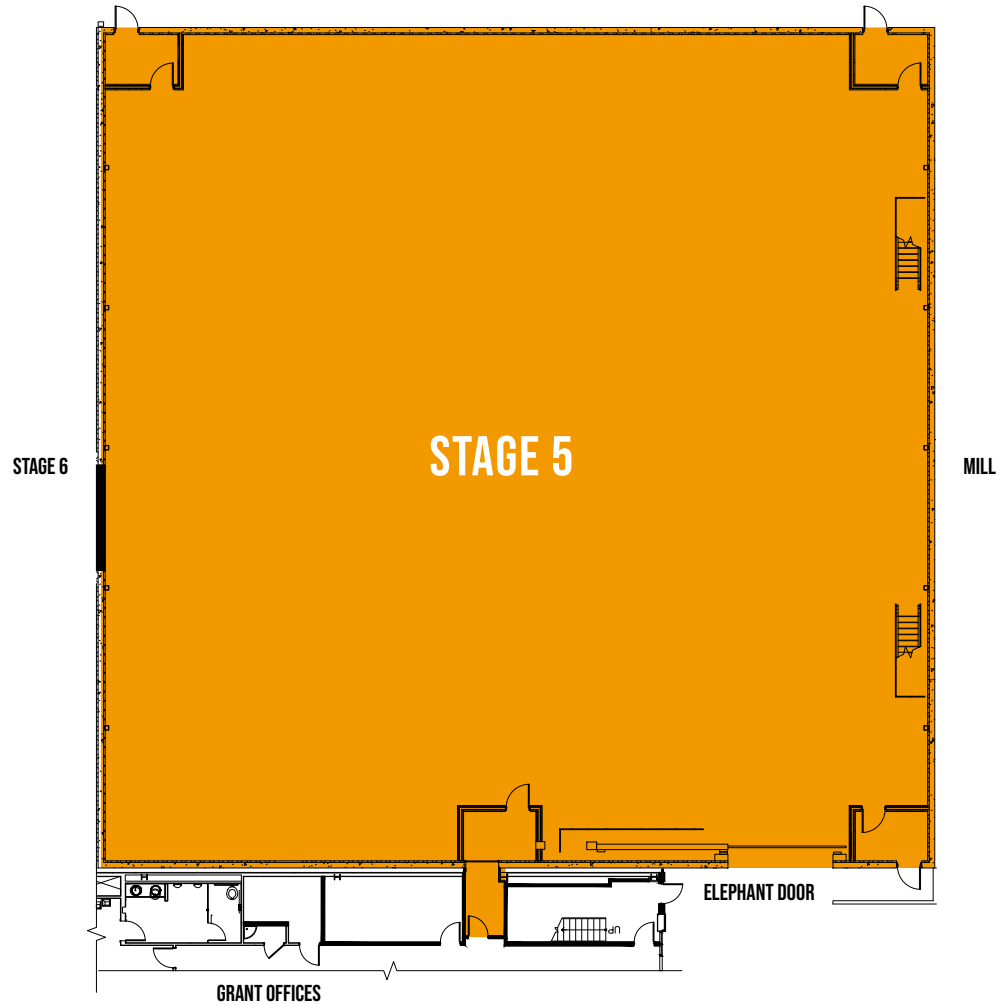

WIDTH	LENGTH	HEIGHT	TOTAL STAGE SQUARE FOOTAGE	FLOOR TYPE	DOOR (WxH)
127'	127'	35'	16,566	WOOD OVER SLAB	15' X 16'2"

*Dimensions are for overall stage size and do not take into account stage irregularities. Production company representative should verify dimensions for particular applications.



SUNSET GLENOAKS · STAGE 5

11100 Peoria St, Sun Valley, CA 91352 · Sales@SunsetStudios.com · (323) 860-8100

STAGE SPECIFICATIONS

Width - 127'

Length - 127'

Height - 35'

Fire Lane - 4'

Total Square Footage - 16,566

Floor Weight Capacity - 300 psf

Elephant Door - 16'x16'2"

Floor Type - 12" thick reinforced concrete slab with nailable wood surface

Ceiling Load Capacity - 25 lbs/sf distributed live load. 1,500 lbs. point load

POWER

750kVA transformer total power 7200 amps, 120/208 VAC

shooting power, (6) 400 amp company switches, (4 stage level, 2 in catwalk level), 1 - 200 amp 120/208 VAC panel

Tech Power - Available

Power In Grid - 2 company switches

HVAC

HVAC - Fully Self Contained (100 ton cooling capacity) package unites

located on the roof with isolators and seismic restraints

Acoustic Rating - NC 25

Redlight Control - Yes

Ventilation - Yes

Heating - Yes

STAGE EXTRAS

Hose Bib - One hose bib

Gas - No

Compressed Air - No