

Stage 4

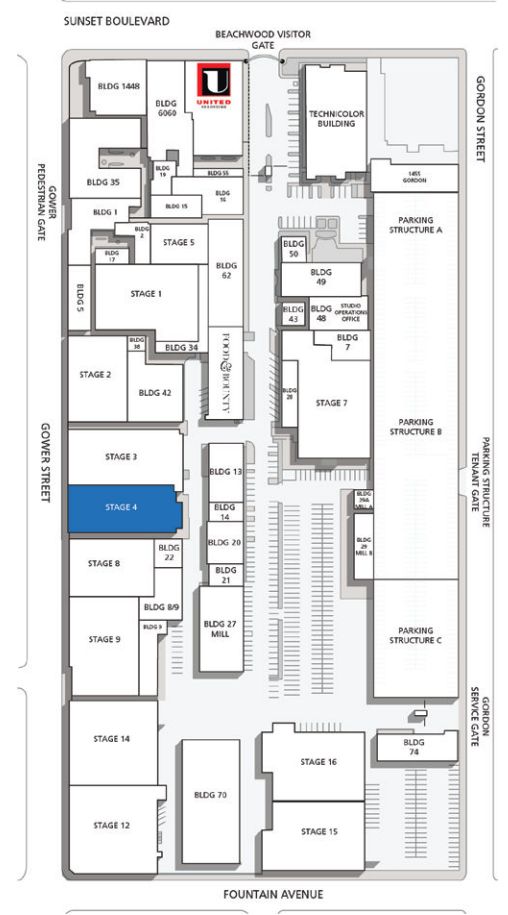

Width	Length	Height (Perms)	Total Stage Square Footage	Floor Type	Door (WxH)
72'7"	157'9"	23'10"	11,678	Wood	11' 1" x 20' 9"

*Dimensions are for overall stage size and do not take into account stage irregularities. Production company representative should verify dimensions for particular applications.

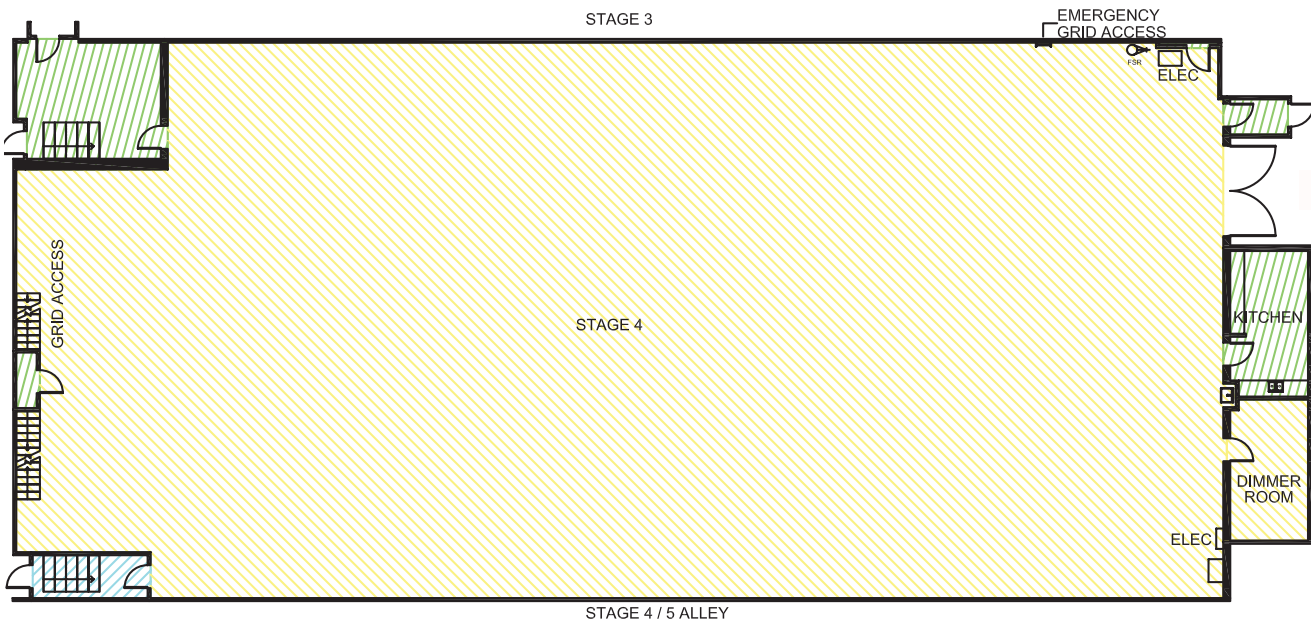
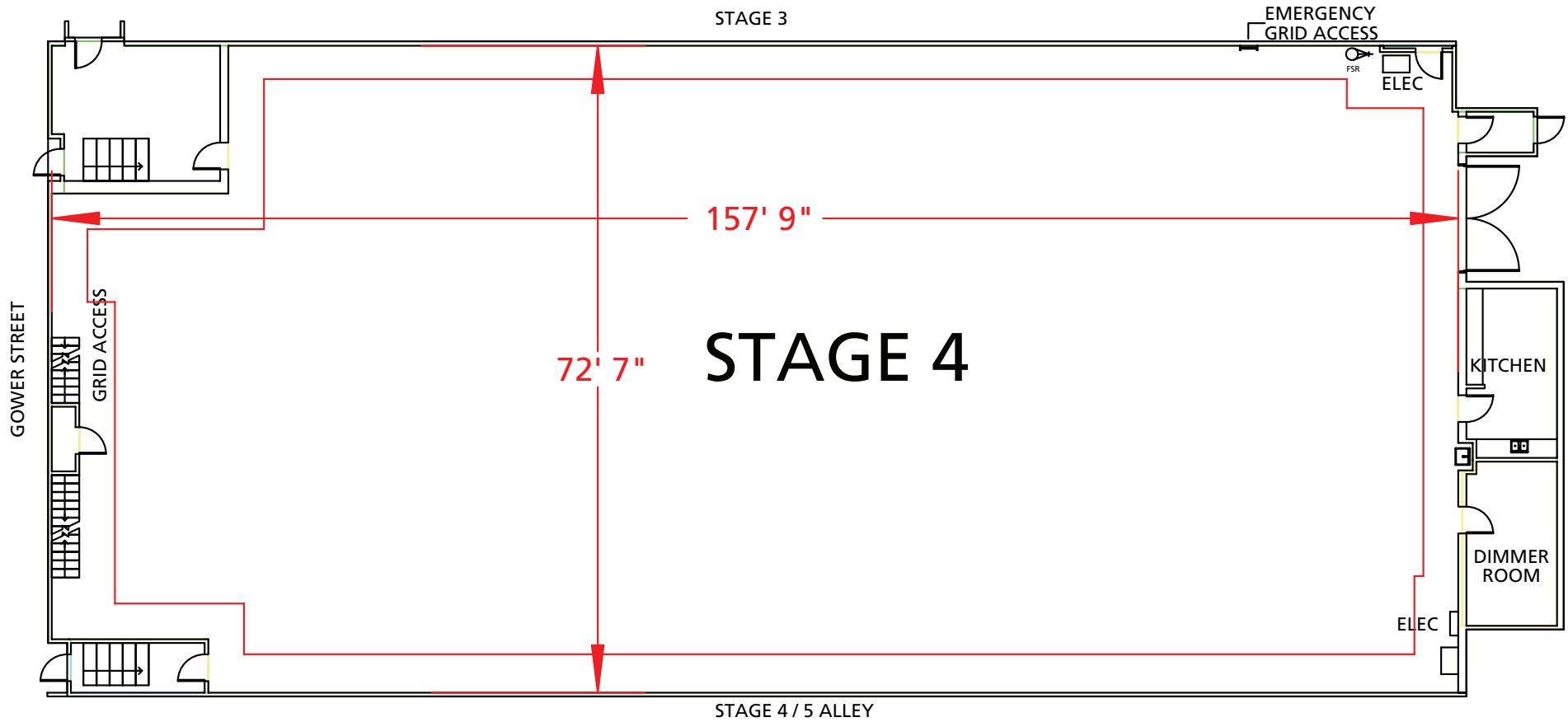

Stage Specifications: Stage 4

Stage Specifications - (Dimensions Include 4' Fire Lane)

Width – 72' 7"

Length – 157' 9"

Height (Perms) – 23' 10"

Total Square Footage – 11,678 sf

Floor Type – Wood

Elephant Door (W X H) – 11' 1" X 2 0' 9"

Full Service Control Room Available On Stage

Support Space- (Available On Stage)

There is a kitchen on stage.

Dressing Rooms, Wardrobe, and Hair + Make Up rooms are available in adjacent buildings

Heavy Equipment

Stage Management to authorize

Electric Service

Production Power - 120/208 800 Amp Per Phase Bus Bar, 4800 Amp Total Standard.

240 Volts - No

480 Volts - No

Tech Power- Available

Power In Grid - Available (Single Phase 120/208)

HVAC

HVAC- (2) 20 Ton (Nominal) Cooling Only Package Units.

HVAC- (4) 10 Ton (Nominal) Cooling/Heat Package Units.

Redlight Control - Yes

Ventilation - Yes

Heating – Yes

Stage Extras

Hose Bib - No

Gas - No

Drain - Yes

Compressed Air - No

Wireless Internet – Available

Phone – Available

Fax – Available