

Stage 6

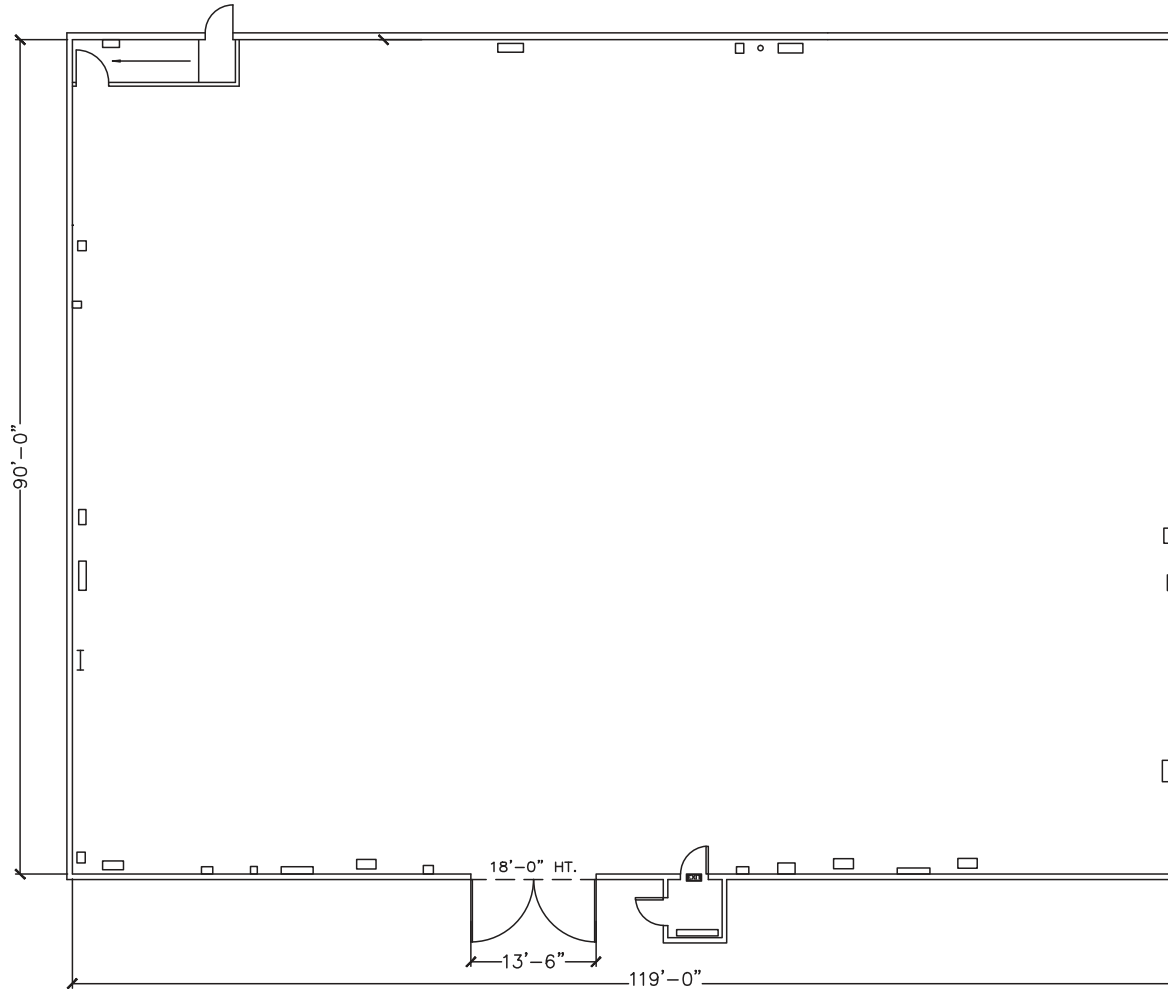

Width	Length	Height (Perms)	Total Stage Square Footage	Floor Type	Door (WxH)
90'	119'	24'	11,276	Wood	13'6" X 18'

*Dimensions are for overall stage size and do not take into account stage irregularities. Production company representative should verify dimensions for particular applications.

Stage Specifications: Stage 6



Stage Specifications

Width – 90'
Length – 119'
Height (Perms) – 24'
Total Square Footage – 11,276 SF
Floor – Wood over slab, small pit
Elephant Door (W X H) – 13'6" X 18'

Additional Info

Audience Rated – No
Drive-In – Yes
Cat Walks – Yes

Heavy Equipment

Stage Management to authorize

Electric Service

Production Power – 1 Switchable buss bar 120/208 Volt @3 phase 1000 amps per phase 3000 amps total
240 Volts – No
480 Volts – No
Tech Power – Available

HVAC

80 tons
Redlight Control – Yes
Ventilation – Yes
Heating – No

Stage Extras

Hose Bib – Yes
Gas – Yes
Drain – No
Compressed Air – Yes
Wireless Internet – Available
Phone – Available
Fax – Available