

Stage 8

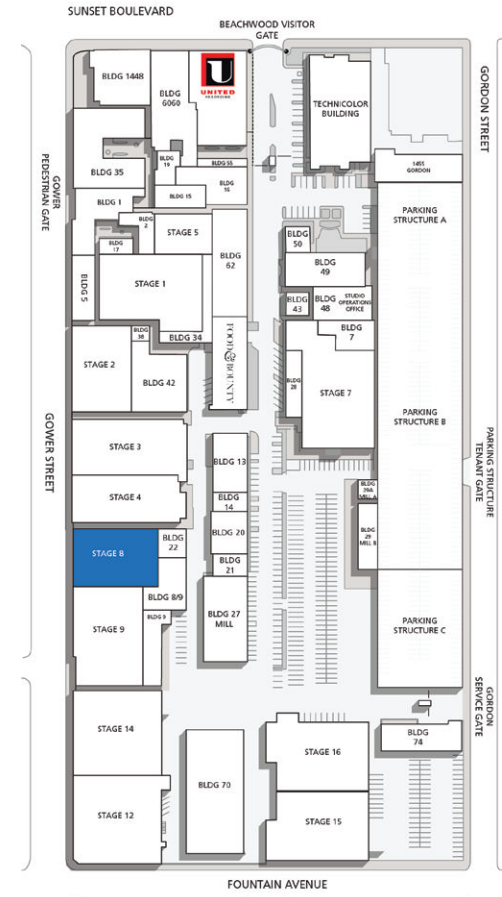

Width	Length	Height (Perms)	Total Stage Square Footage	Floor Type	Door (WxH)
83'	126'5"	35'4"	10,916	Wood	15'2" x 20'

*Dimensions are for overall stage size and do not take into account stage irregularities. Production company representative should verify dimensions for particular applications.

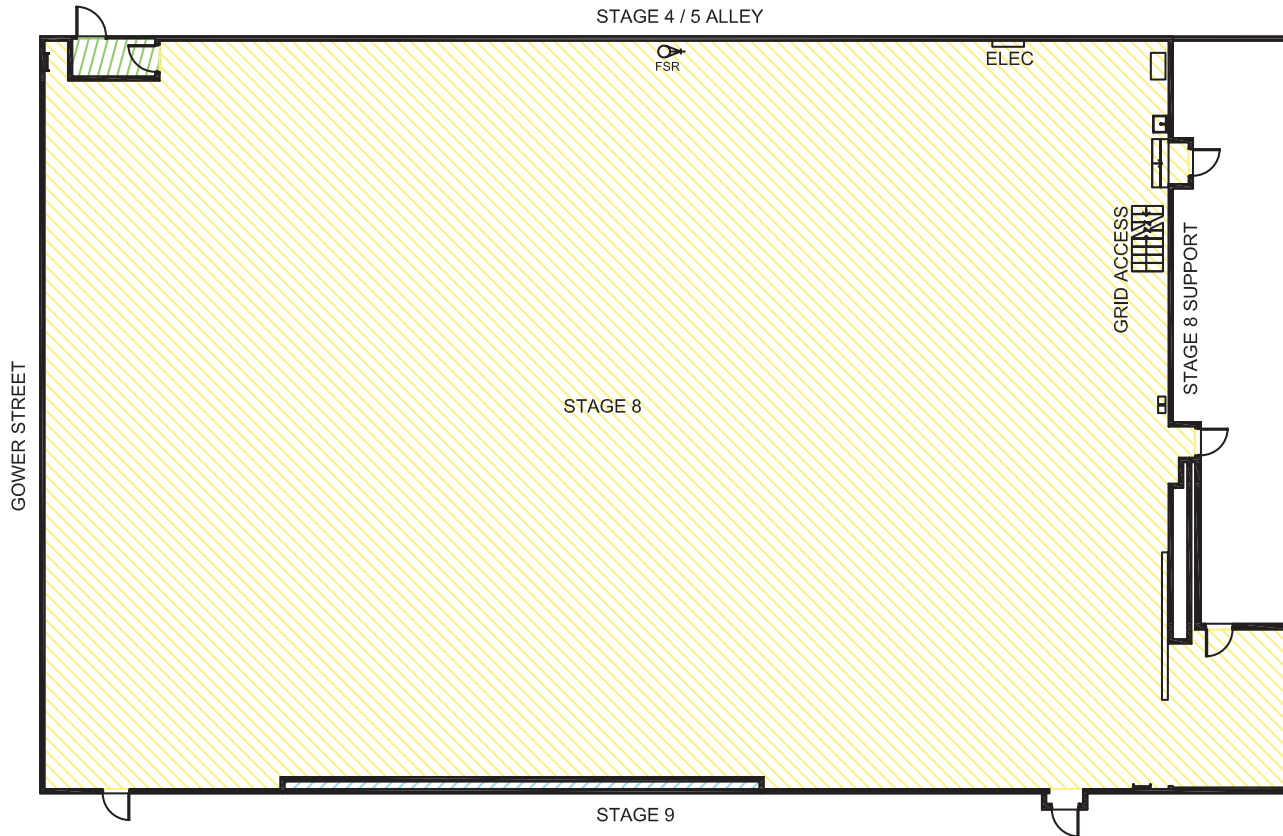
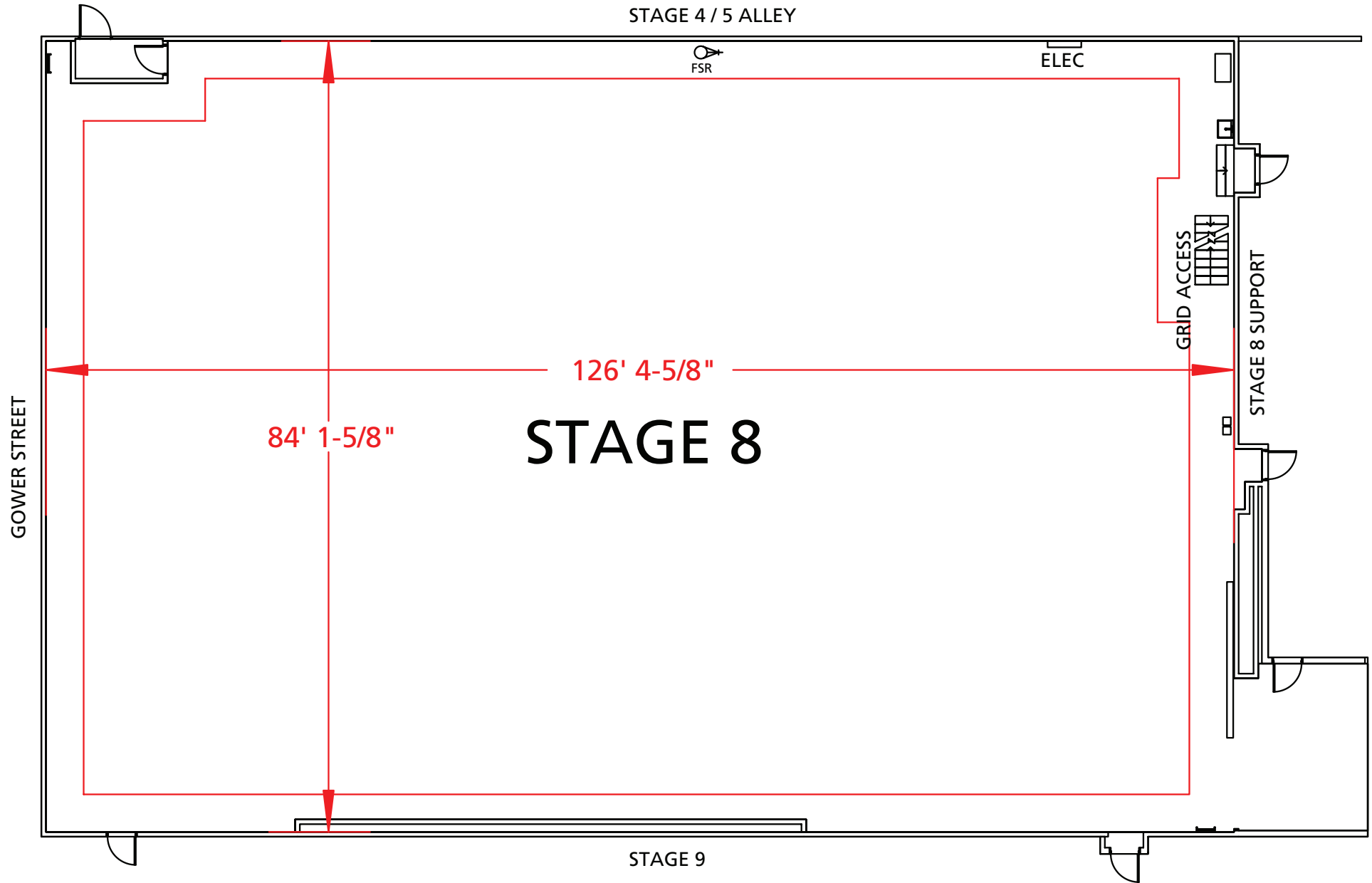

Stage Specifications: Stage 8

Stage Specifications - (Dimensions Include 4' Fire Lane)

Width – 83'
Length – 126' 5"
Height (Perms) – 35' 4"
Total Square Footage – 10,916
Floor Type – Wood
Elephant Door (W X H) – 15' 2" X 20'

Support Space- (Available On Stage)

Support 8: 1 Green Room 2 Support Rooms
Support 8/9: 4 Support Rooms 1 Kitchen (Shared With Stage 9)

Heavy Equipment

Stage Management to authorize

Electric Service

Production Power - 120/208 800 Amp Per Phase Bus Bar, 4800 Amp Total Standard. Additional 2400 Amps Available
240 Volts - No
480 Volts - No
Tech Power - Available
Power In Grid – Available

HVAC

33 Ton (Nominal) Cooling Only Package Unit
33 Ton Cooling / Heat Package Unit
Redlight Control - Yes
Ventilation - Yes
Heating – Yes

Stage Extras

Hose Bib - No
Gas - No
Drain - Yes
Compressed Air - No
Wireless Internet – Available
Phone – Available
Fax – Available